

Network Video Recorder Quick Start Guide

Welcome!
Lets get started.



Getting to know your NVR

Congratulations on the purchase of your Swann NVR. This quick start guide will assist you on getting your NVR up and running as soon as possible. We recommend that you connect everything and give it a try before you do a permanent installation, to make sure nothing was damaged during shipping. On the other side is a detailed connection map which illustrates the various connections on the NVR.

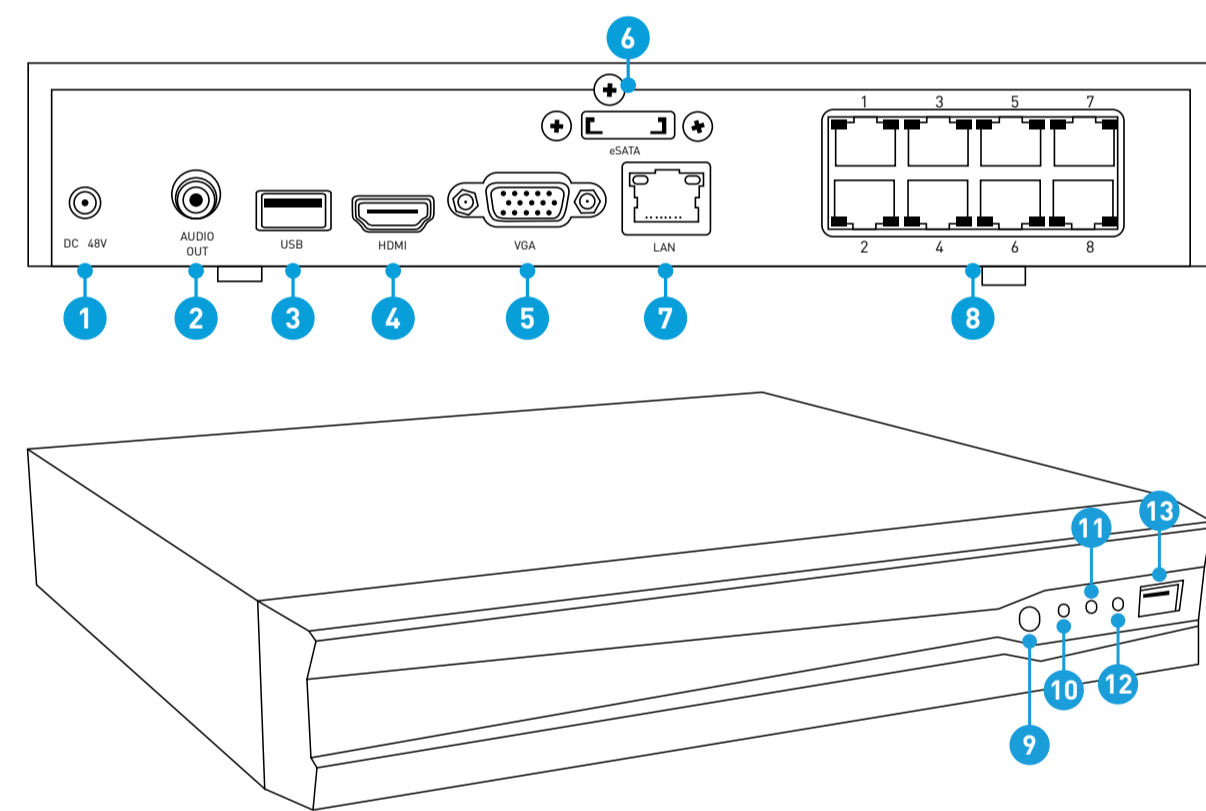

- 1) Power
- 2) Audio Out
- 3) USB
- 4) HDMI
- 5) VGA
- 6) eSATA
- 7) LAN
- 8) Camera Inputs
- 9) IR Receiver
- 10) Power LED
- 11) HDD LED
- 12) LAN LED
- 13) USB

What does this mean?

Here are explanations for the various connections and lights on the NVR -

- 1) **Power** - This is where you connect the power adapter.
- 2) **Audio Out** - For connecting speakers.
- 3) **USB** - Connect the mouse here.
- 4) **HDMI** - If you have a digital TV with HDMI input, connect this to an available input.
- 5) **VGA** - If you have a digital TV or a monitor with VGA input, connect this to an available input.
- 6) **eSATA** - An easy way to connect an additional Hard Drive for extra storage.
- 7) **LAN** - Connect this to your home network so your NVR can connect to the Internet.
- 8) **Camera Inputs** - Plug the camera cables here.
- 9) **IR Receiver** - Receives a signal from the included remote control.

- 10) **Power LED** - When the NVR has power, this light will turn on.
- 11) **HDD LED** - This will flash when the hard drive is working.
- 12) **LAN LED** - This will flash when there is network activity.
- 13) **USB** - Able to connect a Flash Drive to backup recorded events or to perform firmware updates.

Connecting the Cameras

To connect your camera(s) to the NVR, simply connect the supplied Ethernet cable to the LAN connection on the camera then plug the other end of the Ethernet cable into one of the camera inputs on the back of the NVR.

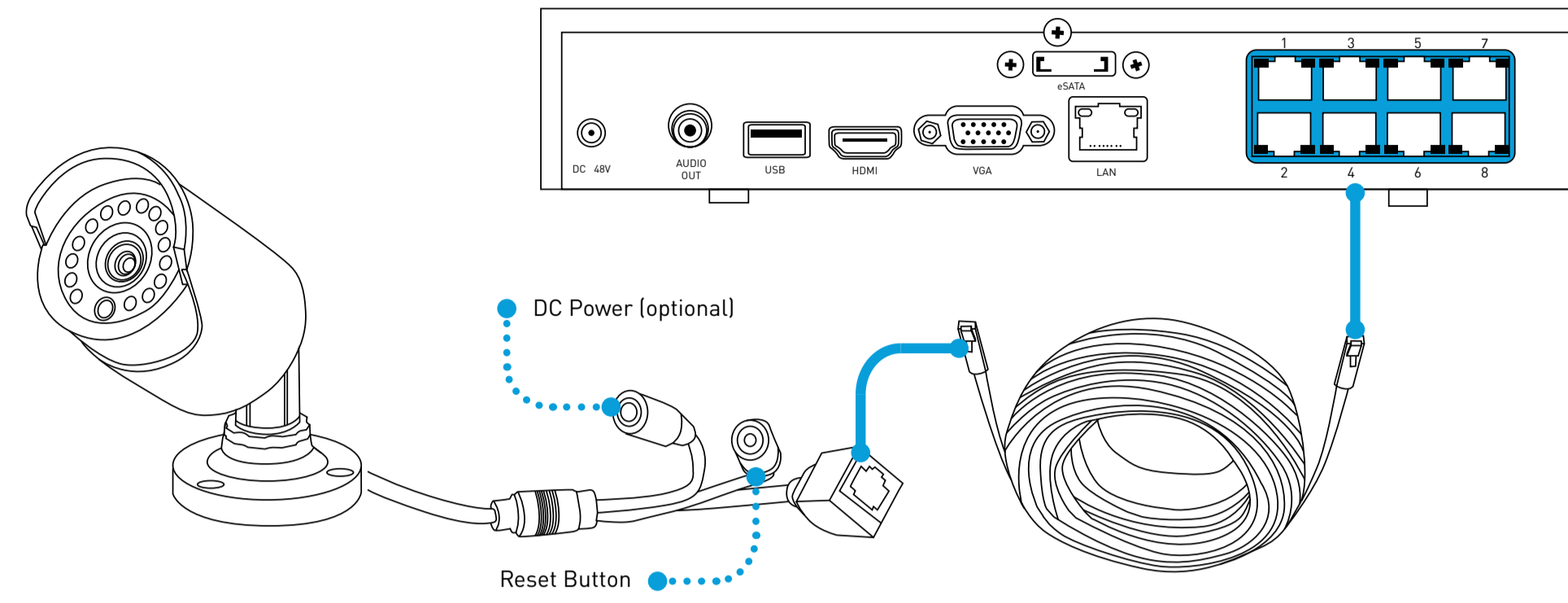

It doesn't really matter which port you use as they are quite versatile and will be configured in a later step. Please note; the Ethernet cable is the same at both ends so it doesn't matter which end plugs into the camera or NVR.

Connect the NVR to your HDTV

Connect the HDMI cable (supplied) to the HDMI input on the NVR, and connect the other end to a spare HDMI input on the TV. Make sure your HDTV input matches the physical connection used to connect your NVR.

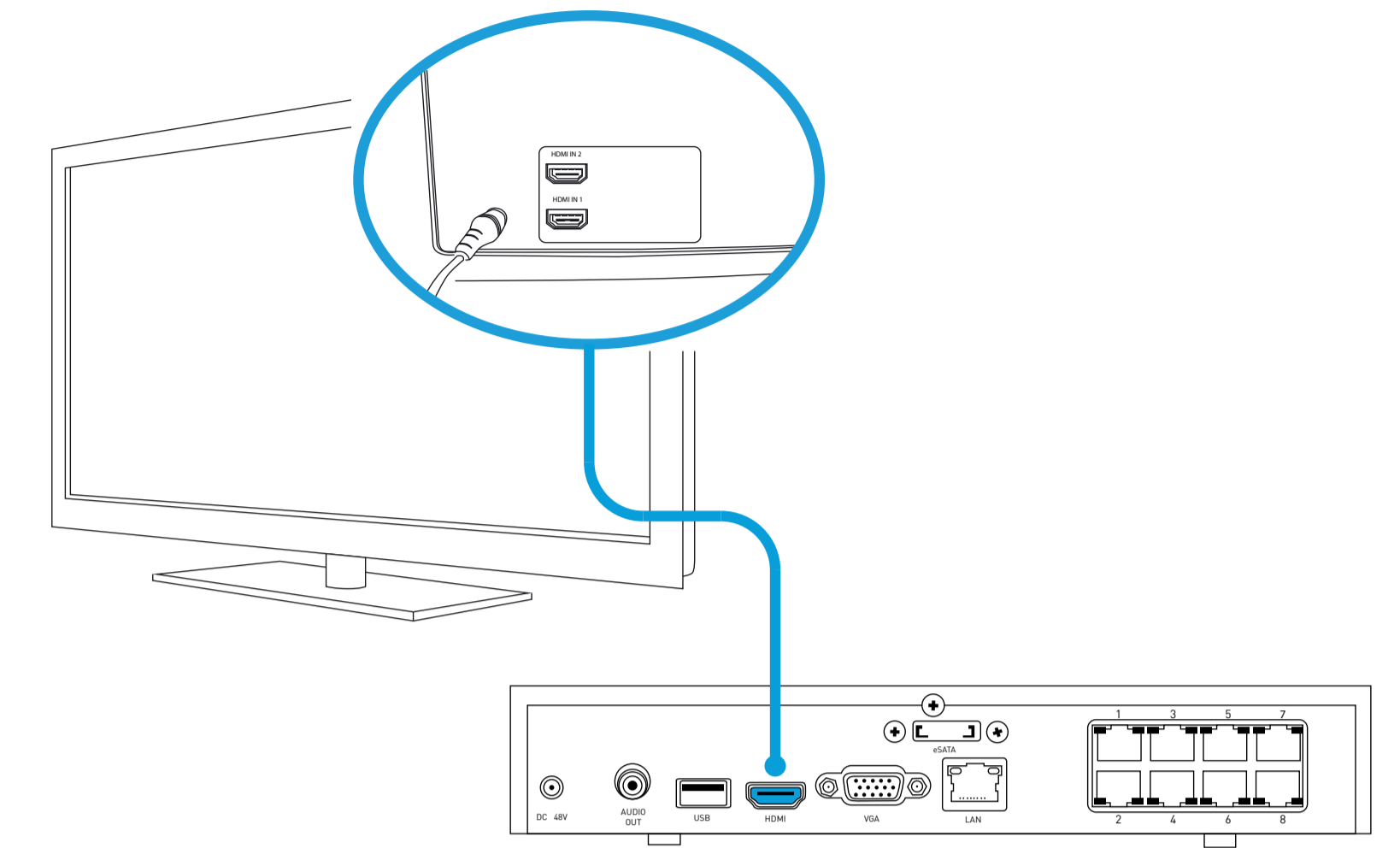

Connect to your Home Network

Connect the Ethernet cable (supplied) to the LAN connection on the NVR, and then connect the other end to a spare port on your router or wireless access point.

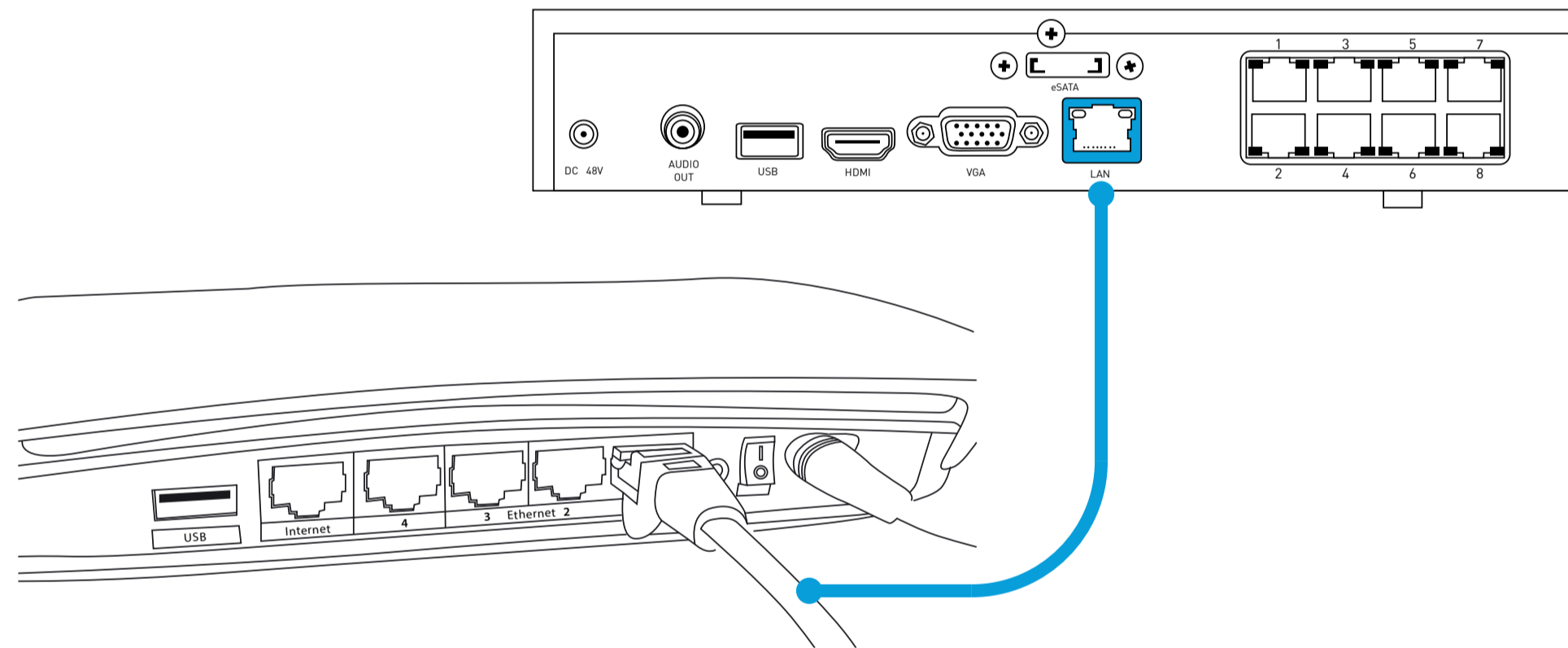

It's important to do this as it allows the NVR to connect to the Internet to update its internal clock so the time it shows on the video is always accurate, to send you email notifications and to access from your smartphone or tablet.

Connect the NVR to your Monitor (optional)

If you have a Monitor with a VGA connection, connect a VGA cable (not supplied) to the VGA output on the NVR, and connect the other end to the VGA input on the Monitor. You can skip this step if you are using the supplied HDMI cable.

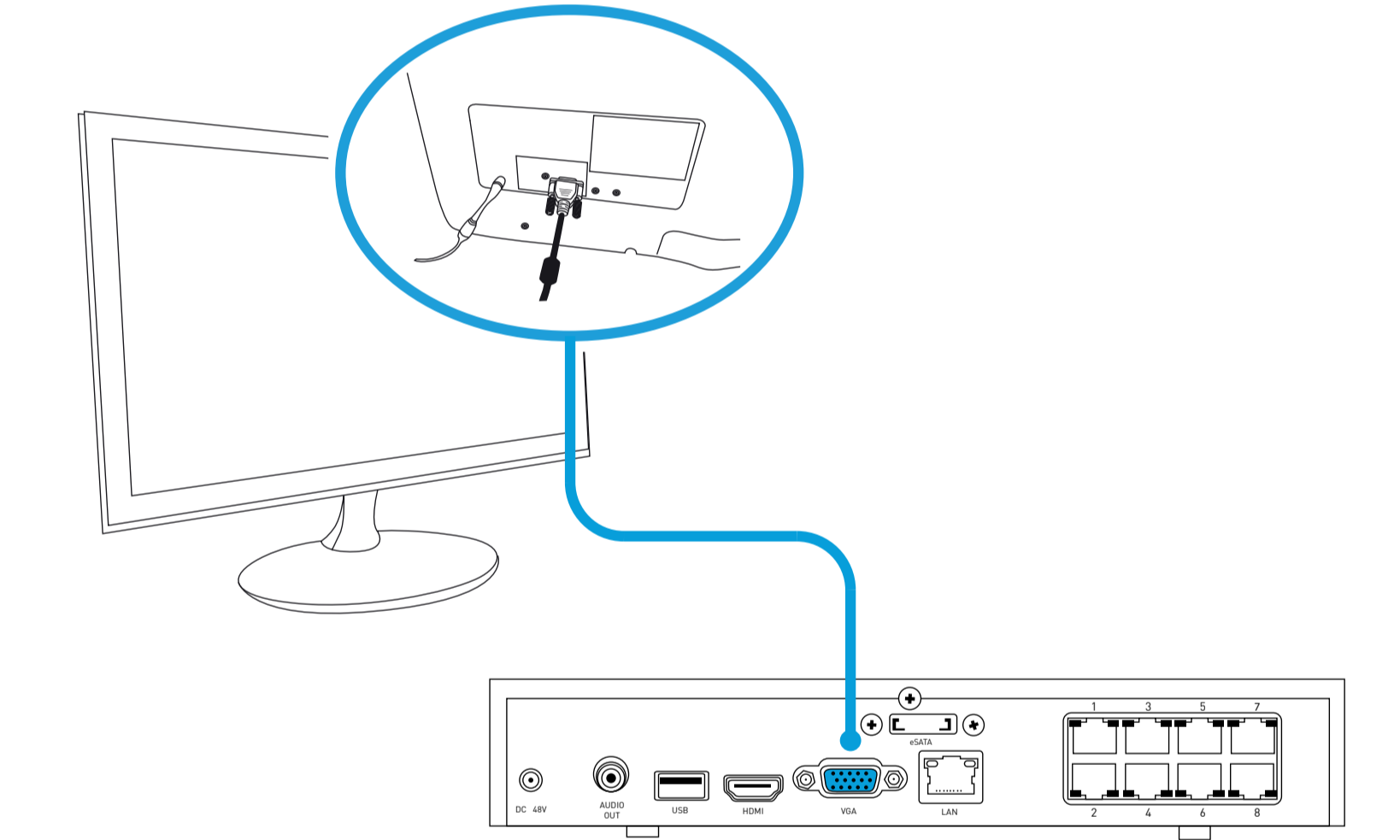

Connect the Mouse

Connect the mouse (supplied) to the USB port located at the rear of the NVR.

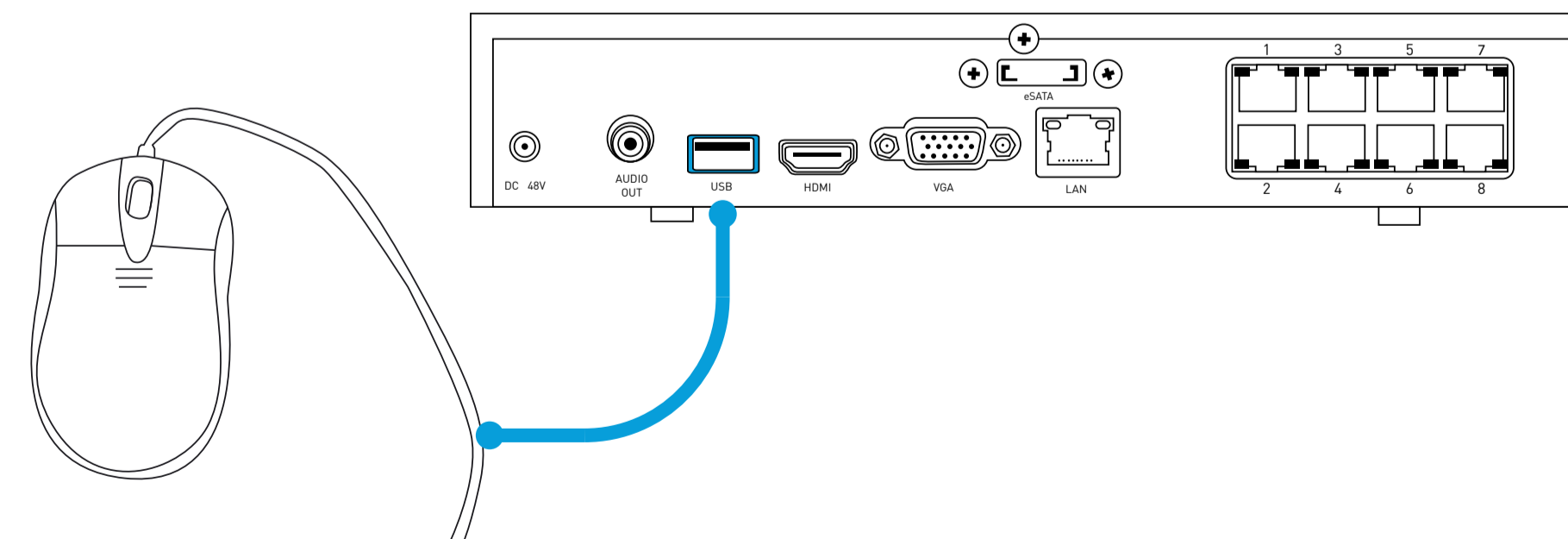

Connect the Power Adapters

Connect the power adapter (supplied) to the power input on the NVR. Connect the power cable (supplied) to the power adapter and plug the other end to a wall socket.

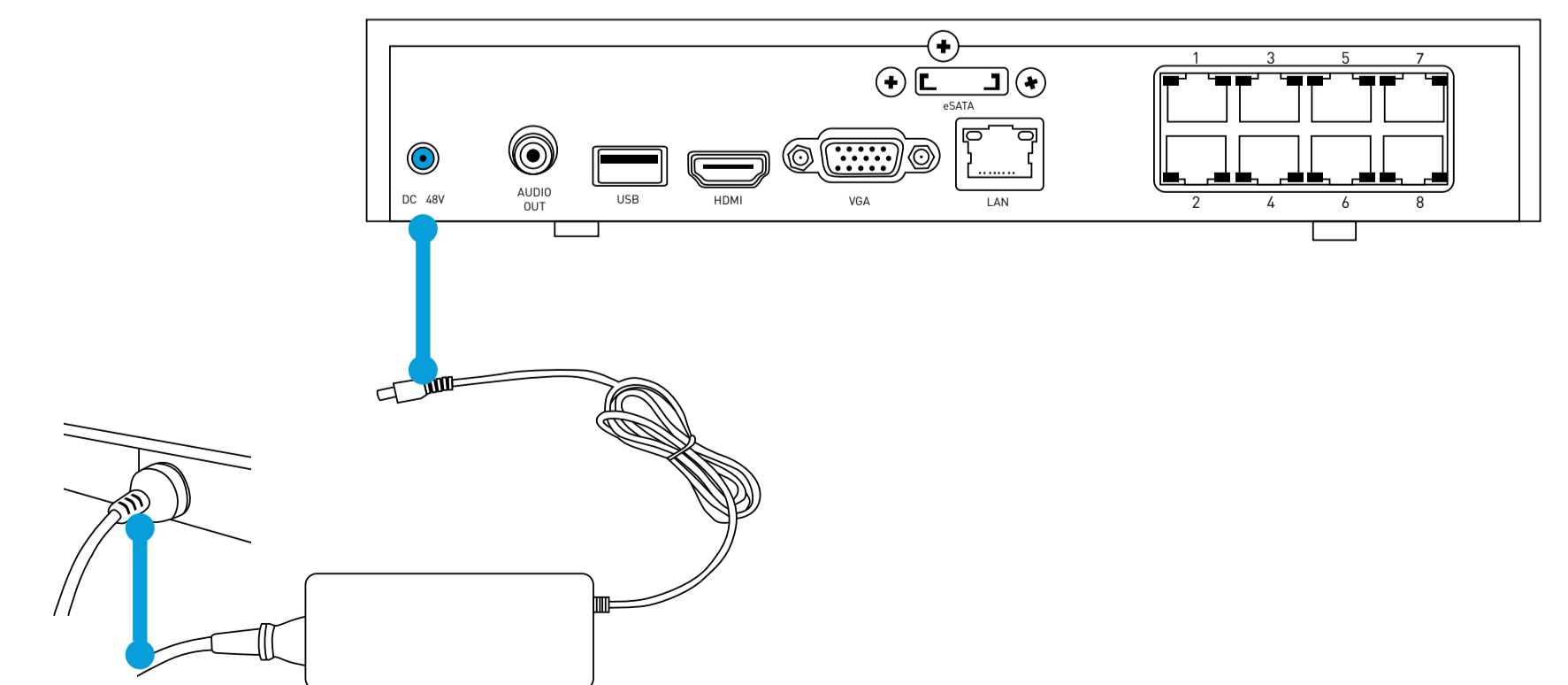

All connections have now been completed. You're now ready to run through "The Setup Wizard" to configure your NVR.

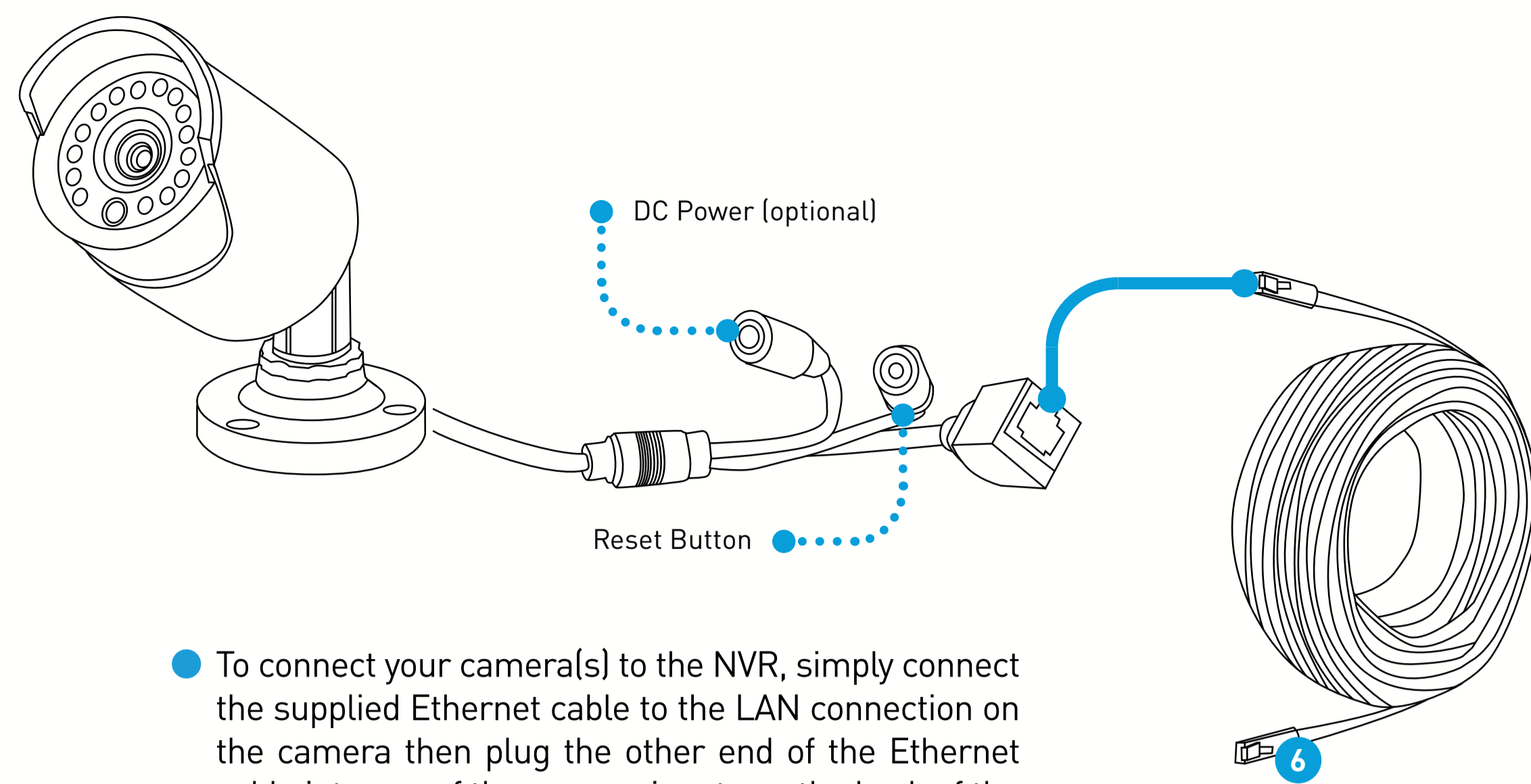

- To connect your camera(s) to the NVR, simply connect the supplied Ethernet cable to the LAN connection on the camera then plug the other end of the Ethernet cable into one of the camera inputs on the back of the NVR. It doesn't really matter which port you use as they are quite versatile and will be configured in a later step. Please note; the Ethernet cable is the same at both ends so it doesn't matter which end plugs into the camera or NVR.

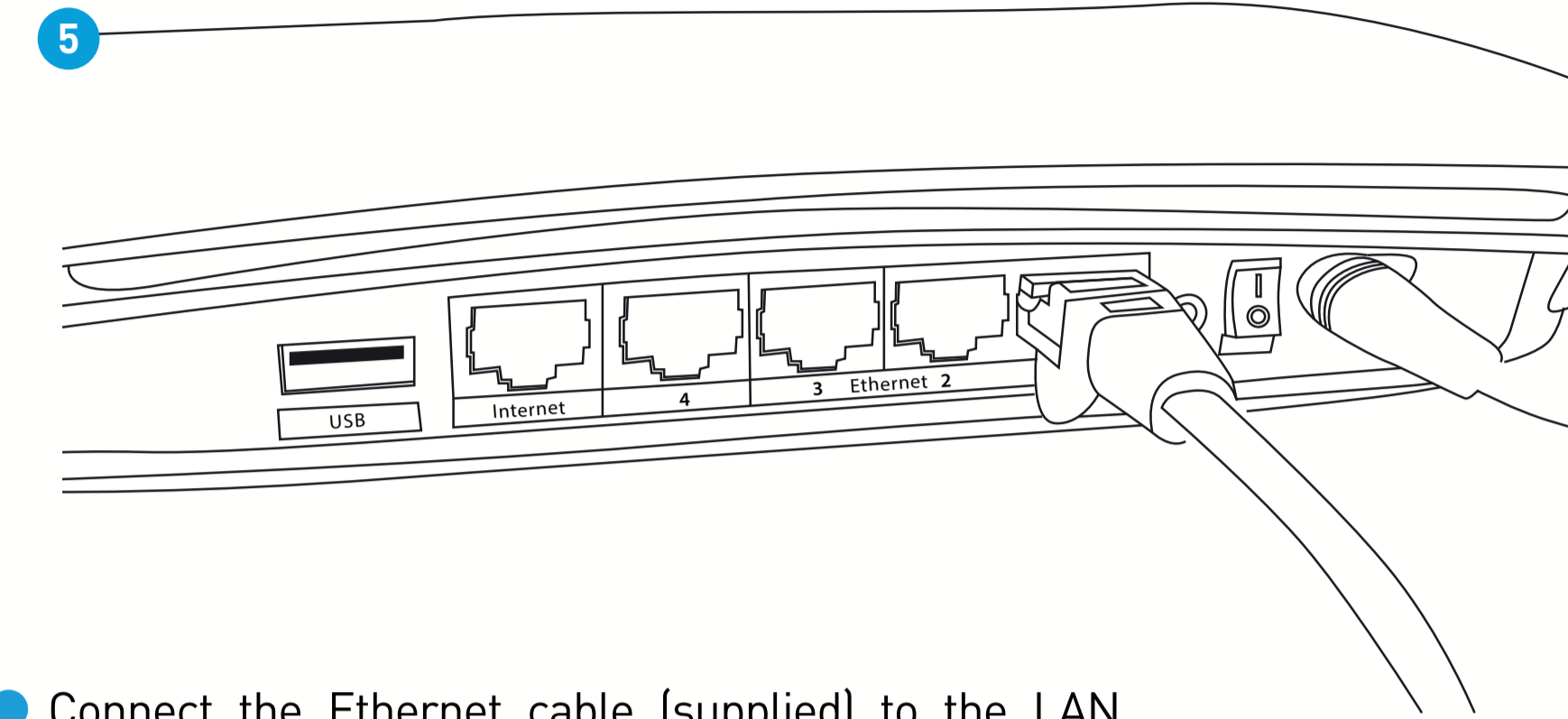

- Connect the Ethernet cable (supplied) to the LAN connection on the NVR, and then connect the other end to a spare port on your router or wireless access point. This allows you to access the NVR from your smartphone or tablet and provides Internet access to your NVR to update its internal clock.

- Connect the mouse (supplied) to the USB port located at the rear of the NVR.

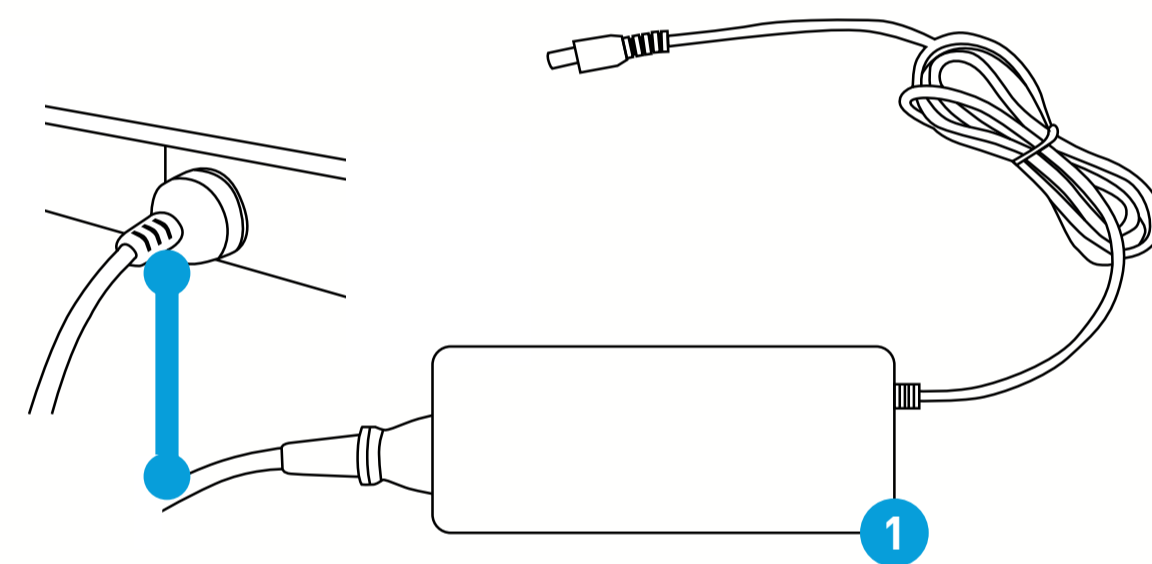

- Connect the power adapter (supplied) to the power input on the NVR. Connect the power cable (supplied) to the power adapter and plug the other end to a wall socket.

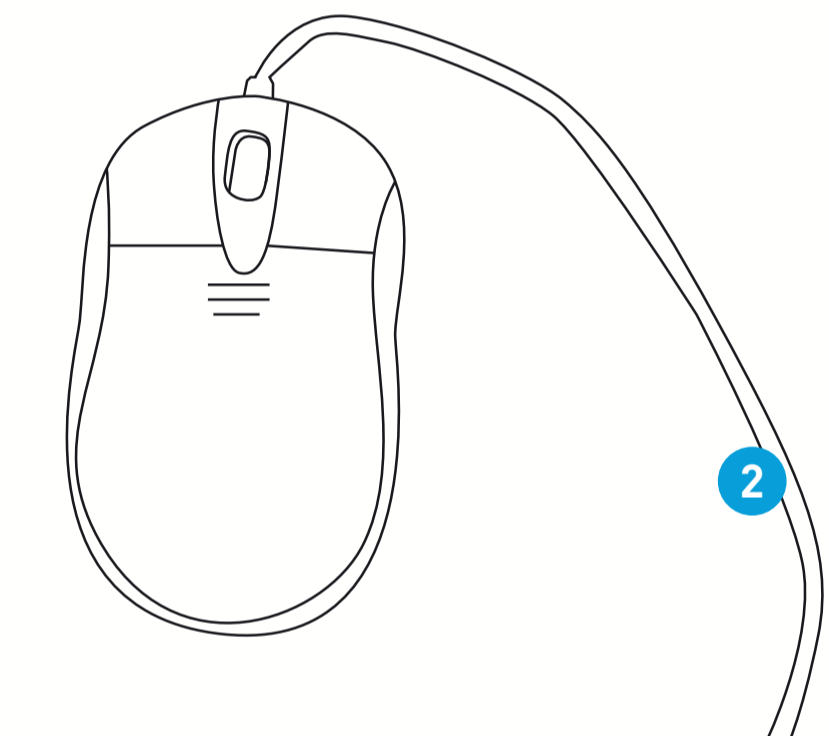
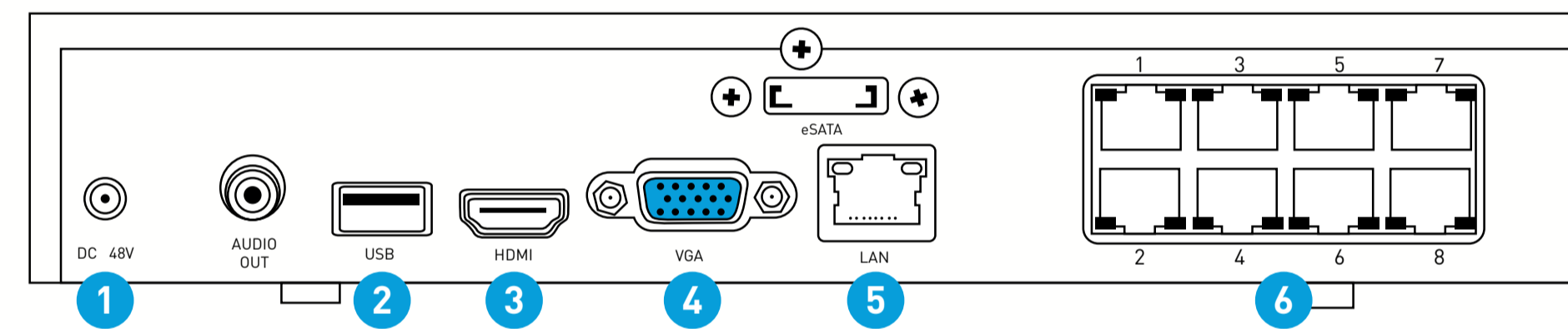

- Connect the HDMI cable (supplied) to the HDMI output on the NVR, and connect the other end to a spare HDMI input on the TV. Make sure your HDTV input matches the physical connection used to connect your NVR.

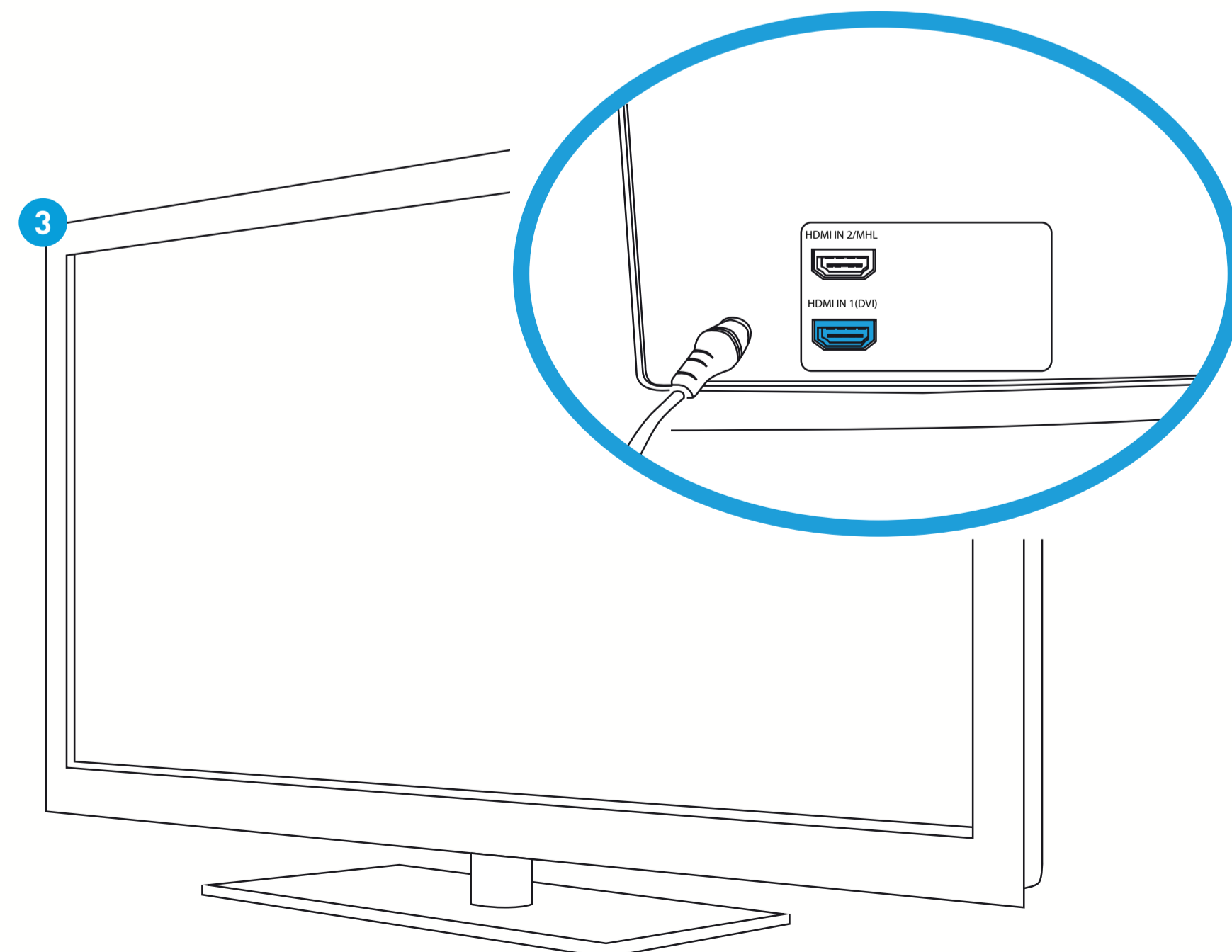

- If your HDTV has a VGA input or you have a monitor with a VGA connection, connect a VGA cable (not supplied) to the VGA output on the NVR, and connect the other end to the VGA input on the HDTV or monitor.

💡 A VGA cable and monitor are not required if you are using the HDMI cable for display.

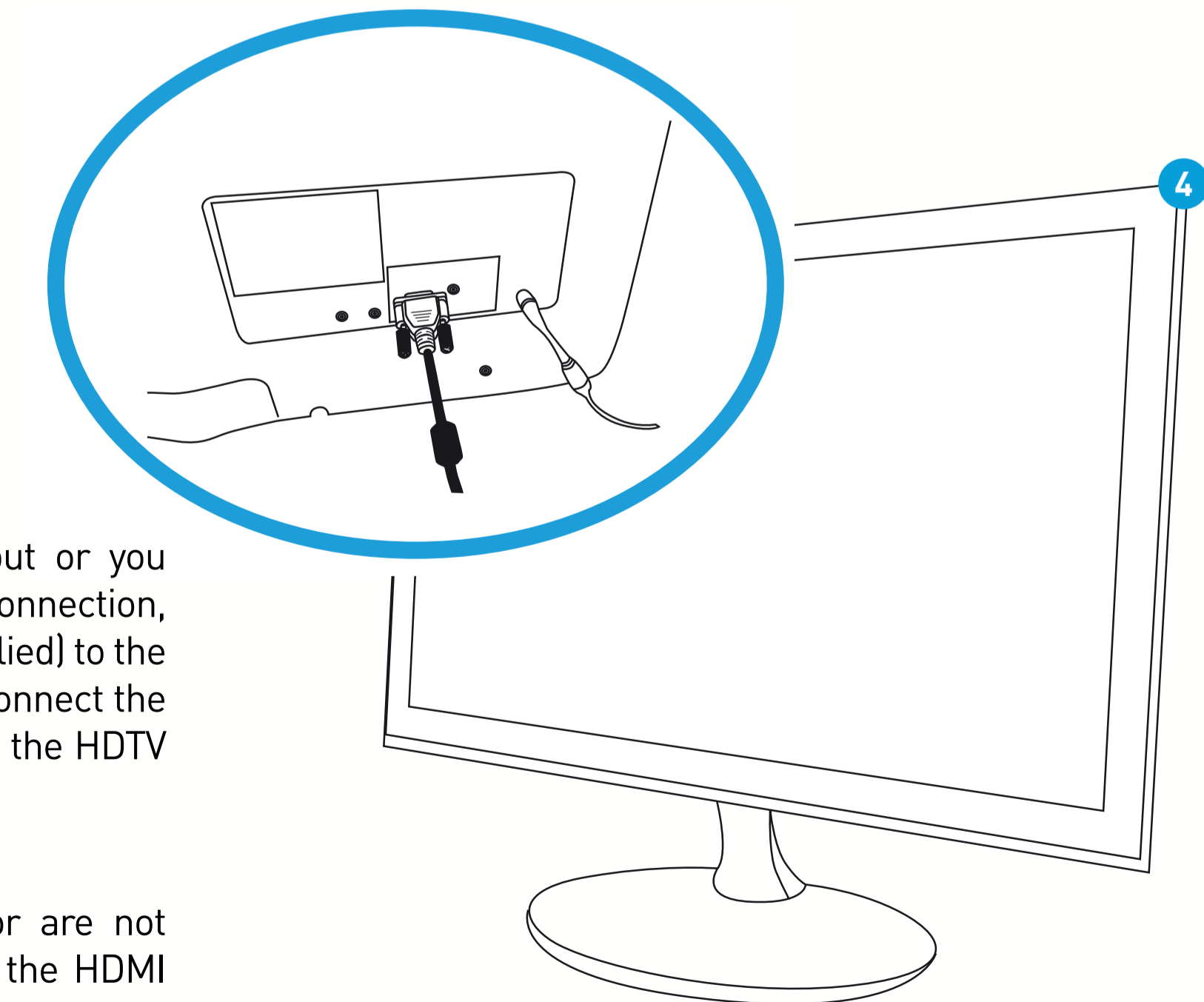

What are the additional connections for?

Audio Out - For connecting speakers.

eSATA - Connect an additional Hard Drive with an eSATA connection to store more video.

DC Power (Camera) - You can connect a separate power adapter (not supplied) to this connection if you would like the camera to have its own power source.

Reset Button (Camera) - Push and hold this button on the camera for at least 5 seconds to reset back to factory default.