

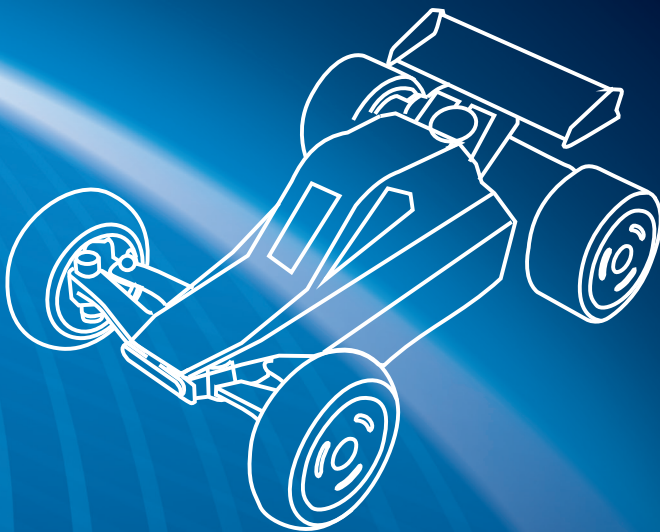

# STINGER

RC Race Car that's easy to drive & hard to put down!

---



**INSTRUCTION MANUAL**

---

# Introduction

Congratulations on your purchase of this *Swann Stinger* Remote Control Vehicle!

This instruction manual will help you with:

- Installing batteries into the provided controller
- Charging the Stinger
- Using the controller

## Safety Precautions



**Choking Hazard** - small parts  
Keep out of reach of small children.



This product is **not** intended for use by children under 14 years old, without proper adult supervision.

- Never drive the vehicle on the road.
- Drive the vehicle on flat, smooth surfaces and in clear open areas. Avoid colliding into walls or hard obstacles to prevent damage.
- Always turn off the vehicle and controller when not in use.
- Always remove the batteries when not in use for extended durations.
- Before turning on your vehicle and controller, ensure no one else is using the same frequency as you are. Frequency interference can cause you to lose control of your vehicle.

## Battery Safety Information

- Controller requires 4 x 1.5V AAA alkaline batteries (not included).
- Do not mix old and new batteries.
- Do not mix different types of batteries, i.e., alkaline, standard or rechargeable batteries.
- Rechargeable batteries must only be charged under adult supervision.
- Do not recharge non-rechargeable batteries.
- Use of alkaline batteries is recommended.
- Remove batteries from controller when it is not used for a long period of time.
- Promptly remove exhausted batteries from the controller. Battery leakage and corrosion can damage the controller.
- Dispose of used batteries responsibly.
- Do not short-circuit the supply terminals.
- Do not store your vehicle or controller under direct sunlight or near heat.

## Care and Maintenance

- To clean, wipe gently with a damp cloth. Avoid use of solvents, as these can damage the plastic components.
- Store the vehicle indoors in room temperature environment and away from heat sources.
- Do not allow water or other liquids to come in contact with the vehicle's battery or other electric components.

## Installing batteries

Remove the battery cover on the bottom of the controller, and insert 4 new "AAA" batteries inside the battery compartment. Follow the polarity (+/-) markings, and then replace the battery cover.

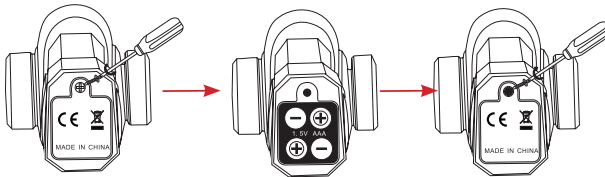

## Charging the Stinger

The Stinger is equipped with a 3.7V Li-ion battery and is not fully charged at shipment. For best performance, charge the Li-ion battery for the first time for at least 2 hours before use. Subsequent charges should take around 30 minutes.

1. To access the charging cable, remove the cover from the controller.

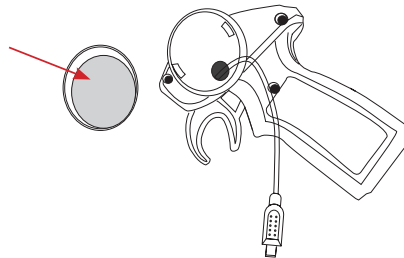

## Charging the Stinger (ctd)

2. Connect the charging cable to the charging interface located underneath the Stinger, and select **"CHG"** on the controller. Make sure the **"ON/OFF"** switch on the Stinger is on the **"OFF"** position. When the Stinger is charging, you will see a green light on the controller. When the stinger is fully charged, the green light will turn off.

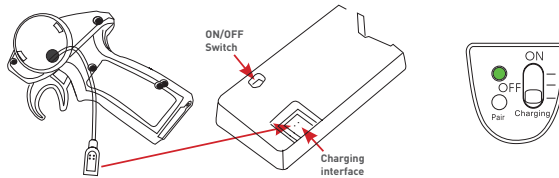

3. Disconnect the charging cable, and place the cover back onto the controller. Make sure the **"ON/OFF"** switch on the Stinger and the controller is on the **"ON"** position. You will see a red light on both the Stinger and the controller.

## Using the Controller

1. **LED Indicator:** When the switch is on the **"ON"** position, you will see a red light. The red light will continually blink when the batteries are running low. When the switch is on the **"CHG"** position, you will see a green light.

2. **Steering Wheel:** Controls the Stinger's steering. Rotate forward to steer right; rotate backward to steer left.

3. **Throttle Trim:** If the Stinger's wheels spin when the throttle trigger is in neutral position, adjust the trim until the wheels come to a complete stop.

4. **Throttle Trigger:** Controls the Stinger's forward and backward movements. Pull the throttle trigger to move the Stinger forward; push the throttle trigger to reverse. The amount of force used on the trigger will determine how fast the Stinger will move.

5. **Speed Control:** This controls how fast or slow the Stinger will operate at. Select **"SLOW"** to operate at a slower speed; select **"FAST"** to operate at a faster speed.

6. **Pair Button:** The Stinger and the provided controller are paired at the factory. Should you need to pair them again, press the **"PAIR"** button on the Stinger. The red light on the Stinger will continually blink. Press the **"PAIR"** button on the controller to pair the controller to the Stinger.

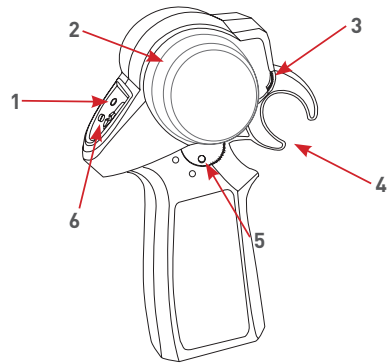

# Steering Trim

If the Stinger does not travel straight when the steering wheel is in a neutral position, adjust the control located on the Stinger. If the Stinger turns to the left, adjust the trim towards the “R” until it travels straight. If the Stinger turns to the right, adjust the trim towards the “L” until it travels straight. The trim is located underneath the front of the Stinger.

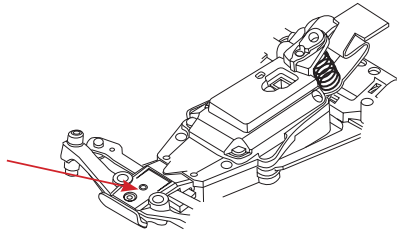

# Troubleshooting

**Q.** The vehicle is slow or does not move.

**A.** The Li-ion battery in the vehicle is low; recharge the battery.

**Q.** The vehicle is out of range.

**A.** Move closer to your vehicle and maintain line of sight. The maximum distance is up to 50 metres.

**Q.** Debris is stuck in the wheels or axles.

**A.** Use a brush to carefully remove the debris from the wheels or axles.

# FCC Compliance Information (for USA)

This device complies with part 15 of the FCC Rules. Operation is subject to the following two conditions: (1) This device may not cause harmful interference, and (2) This device must accept any interference received, including interference that may cause undesired operation.

## **WARNING**

Modifications not approved by the party responsible for compliance could void user's authority to operate the equipment.

# Helpdesk / Technical Support Details

---

## Swann Technical Support

All Countries E-mail: [tech@swann.com](mailto:tech@swann.com)

### Telephone Helpdesk

<b>USA Toll Free</b>	1-800-627-2799
<b>USA Exchange &amp; Repairs</b>	1-800-627-2799 (Option 1) (M-F, 9am-5pm US PT)
<b>AUSTRALIA</b>	1300 138 324
<b>NEW ZEALAND Toll Free</b>	0800 479 266
<b>UK</b>	0203 027 0979

